

FTC (Side Outlet)

Standard Custom Form



SCAN
FOR PDF
DOWNLOAD



FT (Side outlet) linear drains are designed for use with liquid applied (cold fluid applied) or fabric sheet membranes. The overall inside length of channel (**A**) is the finished length of the drain, with a 1-1/16" flange on all four sides to accept the waterproofing membrane. All outlet locations (**B**) are measured from the right inside channel edge. For this type of installation a mortar bed or equal is created up to and around the drain with the appropriate slope towards the drain. The waterproofing is applied over the mortar bed and the flange of the channel. Tile or stone is applied directly to the waterproofing for a low profile installation.

Speciality channel options are available.

- **OCS** for Schuler®-KERDI Waterproofing - KERDI membrane factory applied to the side outlet channel. Uses a 2" No-Hub Outlet.
- **OCH** for Threaded Connection - This channel is provided with a 2" male tapered thread (MPT) for direct threaded connection to a female threaded pipe.

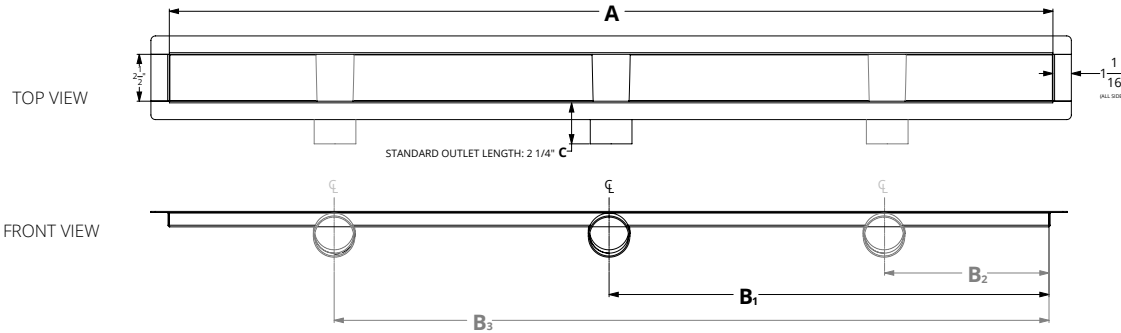

| A: Overall Inside Length | B1: Outlet Location 1 | B2: Outlet Location 2 | B3: Outlet Location 3 | C: Outlet Length |
|----------------------------------|-----------------------|-----------------------|-----------------------|------------------|
| | | | | |
| FOR ADDITIONAL OUTLETS IF NEEDED | | | | IF NOT STANDARD |

Channel Option: **Choose (1)**

☐ **FT Standard (OC 65 Channel)**
2" No Hub Outlet

☐ **OCS Standard**
Factory applied KERDI - 2" No Hub Outlet

☐ **OCH Tapered Threaded**
2" MPT Outlet

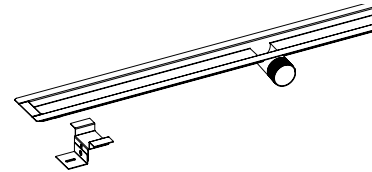
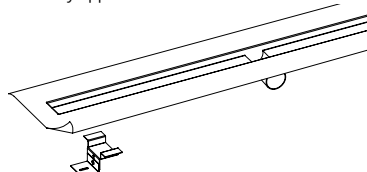
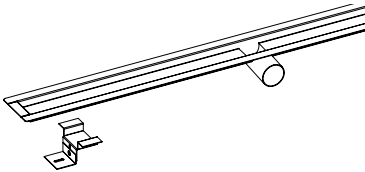

Note: Lengths exceeding the grate's maximum single length will be split into equal sections.

| Grate Styles - Choose (1) Below | | OR | Channel Only <input type="checkbox"/> |
|---|--|----|---|
| FTAS 25 <input type="checkbox"/> 1" WIDE WEDGE WIRE SA 25 GRATE Maximum Single Grate Length: 72" | | | FTED 65 <input type="checkbox"/> OFFSET OVAL PATTERN EA 65 GRATE Maximum Single Grate Length: 96" |
| FTAS 38 <input type="checkbox"/> 1 1/2" WIDE WEDGE WIRE SA 38 GRATE Maximum Single Grate Length: 72" | | | FTMN 65 <input type="checkbox"/> MARC NEWSON PATTERN MA 65 GRATE Maximum Single Grate Length: 96" |
| FTAS 65 <input type="checkbox"/> 2 1/2" WIDE WEDGE WIRE SA 65 GRATE Maximum Single Grate Length: 72" | | | FTSD 65 <input type="checkbox"/> SOLID GRATE SG 65 GRATE Maximum Single Grate Length: 96" |
| FTTAF 65 <input type="checkbox"/> TILE INSERT TA 65 GRATE Maximum Single Grate Length: 60" | | | FTTIF 65 <input type="checkbox"/> TILE INSERT RA 65 GRATE Maximum Single Grate Length: 60" |
| FTLT 38 <input type="checkbox"/> 1 1/2" WIDE OFFSET SLOTTED PATTERN KA 38 GRATE Maximum Single Grate Length: 96" | | | FTLT 65 <input type="checkbox"/> OFFSET SLOTTED PATTERN KA 65 GRATE Maximum Single Grate Length: 96" |

Grate Finish - **Choose (1)**

- ☐ Satin Stainless (SS)
- ☐ Polished Stainless (PS)
- ☐ Oil Rubbed Bronze (ORB)
- ☐ Satin Bronze (SB)
- ☐ Matte Black (BK)
- ☐ Gunmetal (GM)
- ☐ Matte White (MW)
- ☐ Satin Champagne (SC)
- ☐ Polished Brass (PB)
- ☐ Polished Gold (PG)
- ☐ Satin Brass (SR)

☐ Custom Finish
(Specify Color to Match)



Custom finishes can be made to match a sample provided by the customer. Contact Infinity Drain for availability of desired finish.

Optional Tile Edge

- ☐ CCL (for 3/8" material)
- ☐ CCH (for 3/4" material)

Terms and Conditions: By signing this form, you are agreeing to the terms and conditions herein. All details and finishes stated are correct. All dimensions are correct and are to be held within a tolerance of +/- 1/16". All other details and dimensions that are specified as "standard" are subject to manufacturer's tolerance and change without notice. We can assume no responsibility for use of superseded or void data. All custom orders are non-cancellable, non-returnable and non-refundable.

Infinity Drain
145 Dixon Avenue
Amityville, NY 11701
Phone: 516.767.6786
Fax: 516.740.3066
www.infinitydrain.com



APPROVAL

NAME

SIGNATURE

JOB NAME/REFERENCE

DATE