

FCB Series

Fixed Flange for
Double Waterproofing

ID Infinity Drain



Available as components

To learn more, use our Component Selector

**Component
Selector**

Features:

- Flange channel with center 2" threaded outlet
TNAS 2" threaded nipple **Included** with channel
- Compatible with traditional waterproofing and bonded waterproofing membranes
NOT Site Sizable®
- Indoor or outdoor use
- Grate can be removed for cleaning
- Flow rate - 9 gpm per outlet

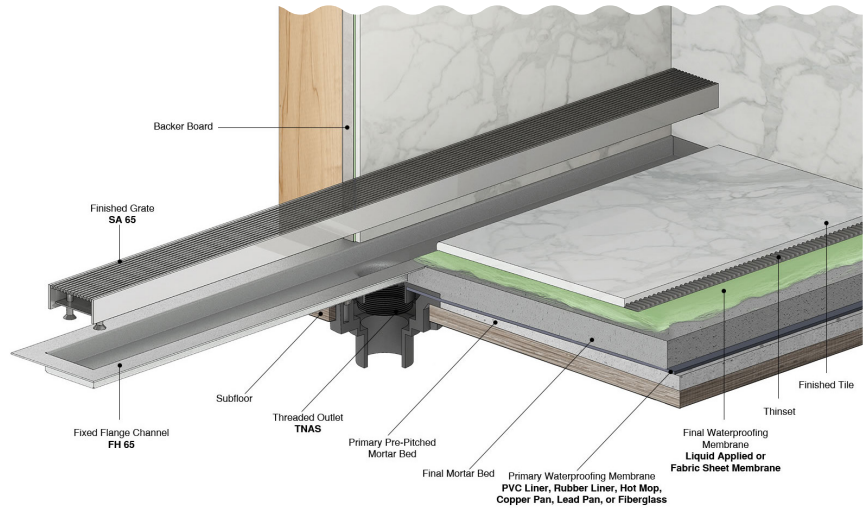

Stainless Steel Channel: FCB 65 Double Waterproofing Channel

All channels are compatible with any standard 2" clamp down drain.

FCB 65 Double Waterproofing Channel



| Size | Model | Overall Dimensions |
|------|----------|---------------------------------|
| 24" | FCB 6524 | 26 1/8" L x 5 7/8" W x 2 1/2" H |
| 32" | FCB 6532 | 34 1/8" L x 5 7/8" W x 2 1/2" H |
| 36" | FCB 6536 | 38 1/8" L x 5 7/8" W x 2 1/2" H |
| 42" | FCB 6542 | 44 1/8" L x 5 7/8" W x 2 1/2" H |
| 48" | FCB 6548 | 50 1/8" L x 5 7/8" W x 2 1/2" H |
| 60" | FCB 6560 | 62 1/8" L x 5 7/8" W x 2 1/2" H |

**SPECIFICATION
SHEET**

Clamp Down Drain Body Required

| Model | Type |
|---------|---------------------|
| CDI 22 | Cast Iron |
| CDIH 22 | Cast Iron (Hot Mop) |
| CDP 22 | PVC |
| CDA 22 | ABS |

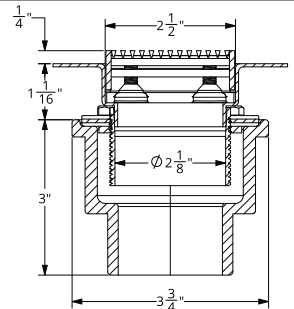

Section View

Decorative Grate Styles:

SA 65 2 MM WEDGE WIRE



| Size | Model |
|------|---------|
| 24" | SA 6524 |
| 32" | SA 6532 |
| 36" | SA 6536 |
| 42" | SA 6542 |
| 48" | SA 6548 |
| 60" | SA 6560 |

**SPECIFICATION
SHEET**

SA 38 2 MM WEDGE WIRE



Requires CI 38

| Size | Model |
|------|---------|
| 24" | SA 3824 |
| 32" | SA 3832 |
| 36" | SA 3836 |
| 42" | SA 3842 |
| 48" | SA 3848 |
| 60" | SA 3860 |

**SPECIFICATION
SHEET**

RA 65 TILE INSERT FRAME



3/8" Depth for Tile

| Size | Model |
|------|---------|
| 24" | RA 6524 |
| 32" | RA 6532 |
| 36" | RA 6536 |
| 42" | RA 6542 |
| 48" | RA 6548 |
| 60" | RA 6560 |

**SPECIFICATION
SHEET**

TA 65 TILE INSERT FRAME



3/4" Depth for Tile

| Size | Model |
|------|---------|
| 24" | TA 6524 |
| 32" | TA 6532 |
| 36" | TA 6536 |
| 42" | TA 6542 |
| 48" | TA 6548 |
| 60" | TA 6560 |

**SPECIFICATION
SHEET**

ADHESION



| Size | Model |
|------|---------|
| 24" | GA 6524 |
| 32" | GA 6532 |
| 36" | GA 6536 |
| 42" | GA 6542 |
| 48" | GA 6548 |
| 60" | GA 6560 |

**SPECIFICATION
SHEET**

OFFSET SLOTTED



| Size | Model |
|------|---------|
| 24" | KA 6524 |
| 32" | KA 6532 |
| 36" | KA 6536 |
| 42" | KA 6542 |
| 48" | KA 6548 |
| 60" | KA 6560 |

**SPECIFICATION
SHEET**

SOLID



| Size | Model |
|------|---------|
| 24" | SG 6524 |
| 32" | SG 6532 |
| 36" | SG 6536 |
| 42" | SG 6542 |
| 48" | SG 6548 |
| 60" | SG 6560 |

**SPECIFICATION
SHEET**

Available for Flanged Channels

Clamping collars can be utilized as a tile edge for standard flange channels. The tile edge is placed on the flanged channel after waterproofing is complete and is adhered to the flange using thinsit. The tile edge can be used with the following channels:

- FF - Fixed Flange
- FCS - Flange with Schluter® Kerdi FCS
- FCB - Double Waterproofing Channel
- OC - Side Outlet Channel

Custom Fabrication Solutions also available



FFC (Fixed Flange)

Standard Custom Form



SCAN
FOR PDF
DOWNLOAD



FF (Flanged) linear drains are designed for use with liquid applied (cold fluid applied) or fabric sheet membranes. The overall inside length of channel (**A**) is the finished length of the drain, with a 1-1/16" flange on all four sides to accept the waterproofing membrane. All outlet locations (**B**) are measured from the right inside channel edge. For this type of installation a mortar bed or equal is created up to and around the drain with the appropriate slope towards the drain. The waterproofing is applied over the mortar bed and the flange of the channel. Tile or stone is applied directly to the waterproofing for a low profile installation. The standard FC channel is provided with a 2" No-Hub Outlet.

Specialty channel options are available.

- FCB** for Double Waterproofing - Comes with a 2" threaded outlet for use with a clamping drain body and a traditional membrane as a primary waterproofing and has the standard 1-1/16" for a liquid/fabric secondary waterproofing.
- FCS** for Schluter®-KERDI Waterproofing - Comes with KERDI membrane factory applied to the channel for use with the Schluter®-KERDI system only. Uses a 2" No-Hub Outlet.
- FCBS** for Double Waterproofing - Comes with a 2" threaded outlet for use with a clamping drain body and a traditional membrane as a primary waterproofing with KERDI membrane factory applied to the channel for use with the Schluter®-KERDI system as secondary waterproofing.
- FCH** for Liquid or Fabric Waterproofing only - Comes with a 2" tapered male threaded outlet (MPT) for direct threaded connection to a 2" female (FPT) fitting.

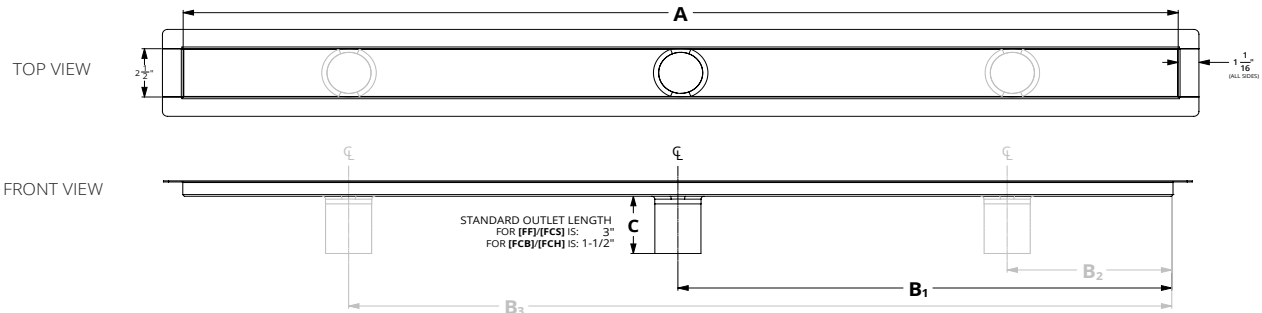

| A: Overall Inside Length | B1: Outlet Location 1 | B2: Outlet Location 2 | B3: Outlet Location 3 | C: Outlet Length |
|--------------------------|-----------------------|----------------------------------|-----------------------|------------------|
| | | | | |
| | | FOR ADDITIONAL OUTLETS IF NEEDED | | IF NOT STANDARD |

Channel Option: **Choose (1)**

- ☐ **FF Standard** 2" No Hub Outlet
 ☐ **FCB Double Waterproofing** 2" Threaded Outlet
 ☐ **FCS Flange with KERDI** Factory applied KERDI with 2" No Hub Outlet
 ☐ **FCBS Double Waterproofing with KERDI** Factory applied KERDI with 2" Threaded Outlet
 ☐ **FCH Tapered Threaded** 2" MPT Outlet

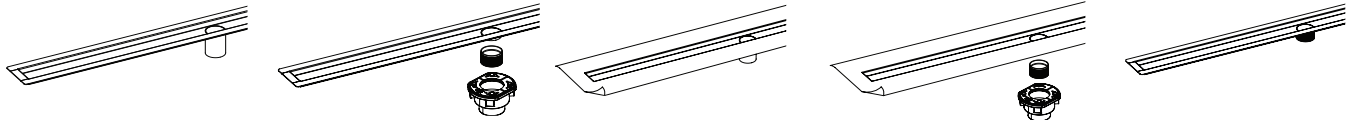

Note: Lengths exceeding the grate's maximum single length will be split into equal sections.

| Grate Styles - Choose (1) Below | | OR Channel Only <input type="checkbox"/> | |
|--|--|--|--|
| FFAS 25 1" WIDE <input type="checkbox"/> WEDGE WIRE SA 25 GRATE Maximum Single Grate Length: 72" | | FFAS 38 1 1/2" WIDE <input type="checkbox"/> WEDGE WIRE SA 38 GRATE Maximum Single Grate Length: 72" | |
| FFAS 65 2 1/2" WIDE <input type="checkbox"/> WEDGE WIRE SA 65 GRATE Maximum Single Grate Length: 72" | | FFED 65 OFFSET OVAL PATTERN EA 65 GRATE Maximum Single Grate Length: 96" | |
| FFAS 100 3 15/16" WIDE <input type="checkbox"/> WEDGE WIRE SA 100 GRATE Maximum Single Grate Length: 72" | | FFMN 65 MARC NEWSON PATTERN MA 65 GRATE Maximum Single Grate Length: 96" | |
| FFAS 125 5" WIDE <input type="checkbox"/> WEDGE WIRE SA 125 GRATE Maximum Single Grate Length: 72" | | FFSG 65 SOLID GRATE SG 65 GRATE Maximum Single Grate Length: 60" | |
| | | FFDG 65 CIRCLE PATTERN PA 65 GRATE Maximum Single Grate Length: 96" | |
| | | FFGR 65 ADHESION PATTERN GA 65 GRATE Maximum Single Grate Length: 96" | |
| | | FFIG 65 SLOTTED PATTERN UA 65 GRATE Maximum Single Grate Length: 96" | |
| | | FFTIF 65 TILE INSERT RA 65 GRATE Maximum Single Grate Length: 60" | |

Grate Finish - **Choose (1)**

- ☐ Satin Stainless (SS)
☐ Polished Stainless (PS)
☐ Oil Rubbed Bronze (ORB)
☐ Satin Bronze (SB)
☐ Matte Black (BK)
☐ Gunmetal
☐ Matte White
☐ Satin Champagne
☐ Polished Brass
☐ Polished Gold

☐ Custom Finish
 (Specify Color to Match)



Custom finishes can be made to match a sample provided by the customer. Contact Infinity Drain for availability of desired finish.

Terms and Conditions: By signing this form, you are agreeing to the terms and conditions herein. All details and finishes stated are correct. All dimensions are correct and are to be held within a tolerance of +/- 1/16". All other details and dimensions that are specified as "standard" are subject to manufacturer's tolerance and change without notice. We can assume no responsibility for use of superseded or void data. All custom orders are non-cancellable, non-returnable and non-refundable.

Infinity Drain
 145 Dixon Avenue
 Amityville, NY 11701
 Phone: 516.767.6786
 Fax: 516.740.3066
 www.infinitydrain.com



APPROVAL

| | |
|-----------|--------------------|
| NAME | JOB NAME/REFERENCE |
| SIGNATURE | DATE |

FM523-11-23

213

For pricing email: quotes@infinitydrain.com