

# Custom Grate

## Standard Custom Grate Form

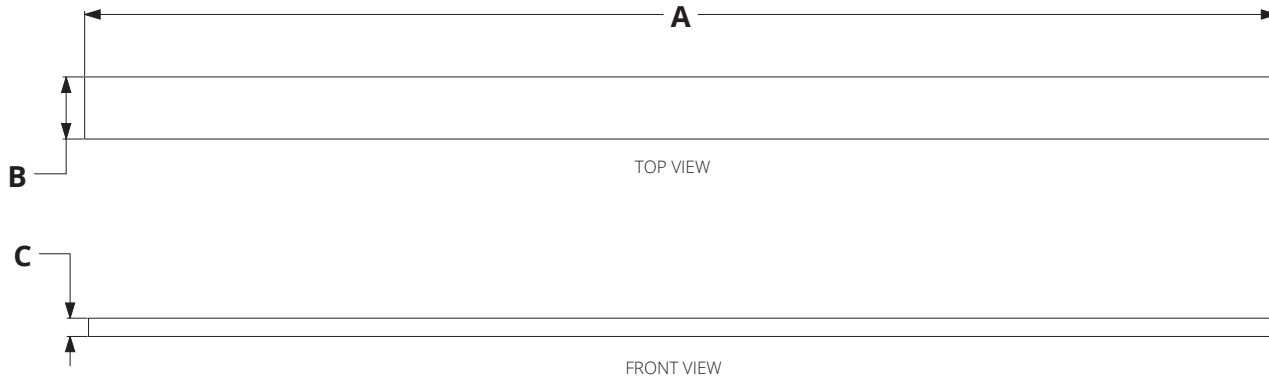
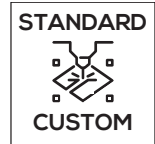

A: Overall Length	B: Overall Width (if not standard)	C: Overall Height (if not standard)
<input type="checkbox"/>	<input type="checkbox"/>	<input type="checkbox"/>

Grate Styles - Choose (1) Below			
<input type="checkbox"/> <b>SA 25</b> 2MM WEDGE WIRE WIDTH: 1" HEIGHT: 1"	<input type="checkbox"/> <b>A 38</b> 3MM WEDGE WIRE WIDTH: 1 1/2" HEIGHT: 1 1/2"	<input type="checkbox"/> <b>LA 65</b> LOW TILE INSERT WIDTH: 2 1/2" HEIGHT: 1" 16 Gauge <small>STANDARD INSERT DEPTH ACCEPTS UP TO 3/8" MATERIAL</small>	<input type="checkbox"/> <b>D 38</b> CIRCLE PATTERN WIDTH: 1 1/2" HEIGHT: 1 1/2" 16 Gauge
<input type="checkbox"/> <b>SA 38</b> 2MM WEDGE WIRE WIDTH: 1 1/2" HEIGHT: 1"	<input type="checkbox"/> <b>A 65</b> 3MM WEDGE WIRE WIDTH: 2 1/2" HEIGHT: 1 1/2"	<input type="checkbox"/> <b>TA 65</b> TILE INSERT WIDTH: 2 1/2" HEIGHT: 1 1/2" 12 Gauge <small>STANDARD INSERT DEPTH ACCEPTS UP TO 3/4" MATERIAL</small>	<input type="checkbox"/> <b>D 65</b> CIRCLE PATTERN WIDTH: 2 1/2" HEIGHT: 1 1/2" 16 Gauge
<input type="checkbox"/> <b>WA 65</b> 2MM WEDGE WIRE WIDTH: 2 1/2" HEIGHT: 3/4"	<input type="checkbox"/> <b>A 100</b> 2MM WEDGE WIRE WIDTH: 3 7/8" HEIGHT: 3/4"	<input type="checkbox"/> <b>RA 65</b> LOW TILE INSERT WIDTH: 2 1/2" HEIGHT: 1" 12 Gauge <small>STANDARD INSERT DEPTH ACCEPTS UP TO 3/8" MATERIAL</small>	<input type="checkbox"/> <b>PA 65</b> CIRCLE PATTERN WIDTH: 2 1/2" HEIGHT: 3/4" 16 Gauge
<input type="checkbox"/> <b>SA 65</b> 2MM WEDGE WIRE WIDTH: 2 1/2" HEIGHT: 1"	<input type="checkbox"/> <b>UA 65</b> SLOTTED PATTERN WIDTH: 2 1/2" HEIGHT: 3/4"	<input type="checkbox"/> <b>EA 65</b> OFFSET OVAL PATTERN WIDTH: 2 1/2" HEIGHT: 3/4" 16 Gauge	<input type="checkbox"/> <b>MA 65</b> MARC NEWSON PATTERN WIDTH: 2 1/2" HEIGHT: 3/4" 16 Gauge
<input type="checkbox"/> <b>SA 125</b> 2MM WEDGE WIRE WIDTH: 4 15/16" HEIGHT: 1"	<input type="checkbox"/> <b>KA 38</b> SLOTTED PATTERN WIDTH: 1 1/2" HEIGHT: 1" 16 Gauge	<input type="checkbox"/> <b>KA 65</b> SLOTTED PATTERN WIDTH: 2 1/2" HEIGHT: 1" 16 Gauge	<input type="checkbox"/> <b>BA 65</b> SOLID GRATE WIDTH: 2 1/2" HEIGHT: 3/4" 7 Gauge

**Grate Finish - Choose (1)**

- Satin Stainless (SS)
- Polished Stainless (PS)
- Matte Black (BK)
- Satin Bronze (SB)
- Oil Rubbed Bronze (ORB)
- Matte White (WH)
- Other (Specify Color to Match)\*  
*Not applicable for Rush*

\* Custom finishes can be made to match a sample provided by the customer. Contact Infinity Drain for availability of desired finish.

**NOTE:** Wedge wire grates and Tile Insert Frame including (SA 25, SA 38, SA 65, SA 125, A 38, A 65, A 100 and LA 65) can not be fabricated in lengths greater than 72".

### Terms and Conditions:

By signing this form, you are agreeing to the terms and conditions herein. All details and finished stated are correct. All dimensions are correct and are to be held within a tolerance of +/- 1/16". All other details and dimensions that are specified as "standard" are subject to manufacturer's tolerance and change without notice. We can assume no responsibility for use of superseded or void data. All custom orders are non-cancellable, non-returnable and non-refundable.

**Infinity Drain**  
145 Dixon Avenue  
Amityville, NY 11701  
Phone: 516.767.6786  
Fax: 516.740.3066  
www.Infinitydrain.com



<b>APPROVAL</b>	NAME <input type="checkbox"/>	JOB NAME/REFERENCE <input type="checkbox"/>
	SIGNATURE <input type="checkbox"/>	DATE <input type="checkbox"/>