

# IC 65 Specifications

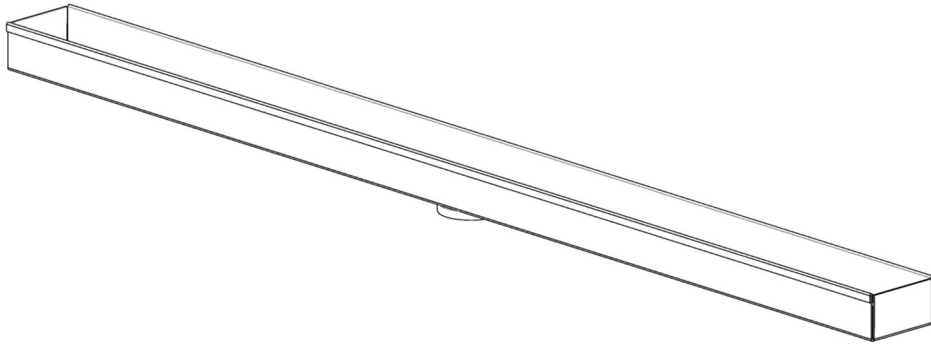

**IC 65:**

- Fixed channel for FX TIF Series
- Waterproofing: Hot Mop, Lead Pan, PVC Vinyl Liner, Rubber Liner, Copper Pan, Fiberglass
- Set Length with center outlet location
- Custom sizes available

**Models** (overall dimension):

- IC 6520: 20-1/8" L x 2-7/8" W x 1-5/8" H
- IC 6540: 40-1/8" L x 2-7/8" W x 1-5/8" H
- IC 6548: 48-1/8" L x 2-7/8" W x 1-5/8" H
- IC 6560: 80-1/8" L x 2-7/8" W x 1-5/8" H
- IC 12560: 62-1/8" L x 4-1/2" W x 3-3/4" H

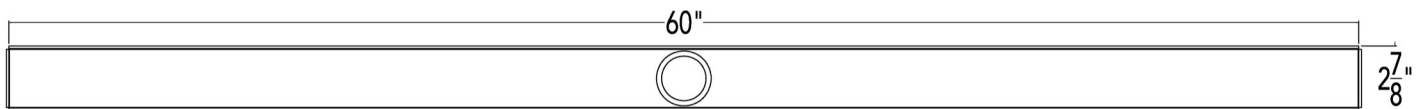
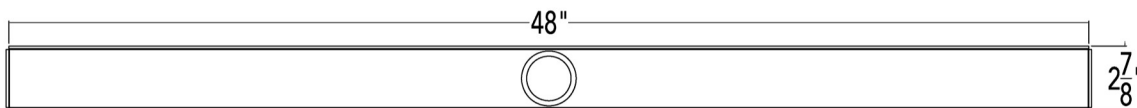
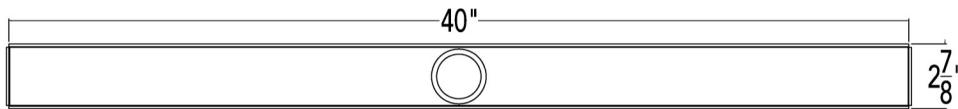
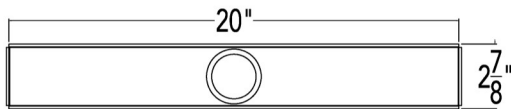
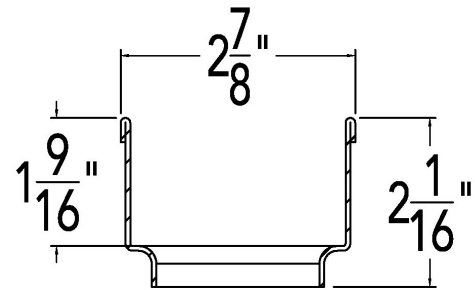

**Infinity Drain**  
 18 Secatoag Avenue  
 Port Washington, NY 11050  
 Phone: 516.767.6786  
 Fax: 516.740.3066  
 www.InfinityDrain.com

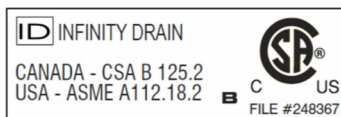

**Note:** Installer must verify all rough-in dimensions prior to installation and consult local and national codes. Conformity and compliance to local and national codes are the responsibility of the installer.