

G 100 Specifications

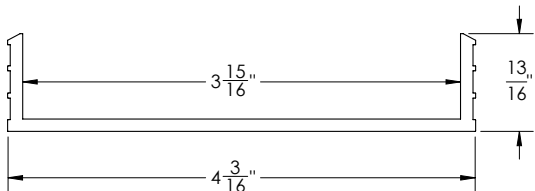

G 100:

- Site Sizable PVC channel for the following models:
S-AG 100 series drains
- Can be cut or extended on site.
- G 100 PVC channel is compatible with the following outlets:
S 50 2" Threaded Outlet, F 65 2" No-Hub Outlet
OR
F 100 3" No-Hub Outlet

Models (overall dimensions):

- G 10048: $47\frac{1}{2}"$ L x $4\frac{3}{16}"$ W x $1\frac{13}{16}"$ H
- G 10096: $95\frac{1}{2}"$ L x $4\frac{3}{16}"$ W x $1\frac{13}{16}"$ H
- G 100108: $107\frac{1}{2}"$ L x $4\frac{3}{16}"$ W x $1\frac{13}{16}"$ H
- G 6560: $57\frac{13}{16}"$ L x $2\frac{15}{16}"$ W x $1\frac{5}{8}"$ H
- G 6572: $69\frac{13}{16}"$ L x $2\frac{15}{16}"$ W x $1\frac{5}{8}"$ H
- G 6580: $77\frac{13}{16}"$ L x $2\frac{15}{16}"$ W x $1\frac{5}{8}"$ H
- G 6596: $93\frac{13}{16}"$ L x $2\frac{15}{16}"$ W x $1\frac{5}{8}"$ H
- G 65108: $180"$ L x $2\frac{15}{16}"$ W x $1\frac{5}{8}"$ H

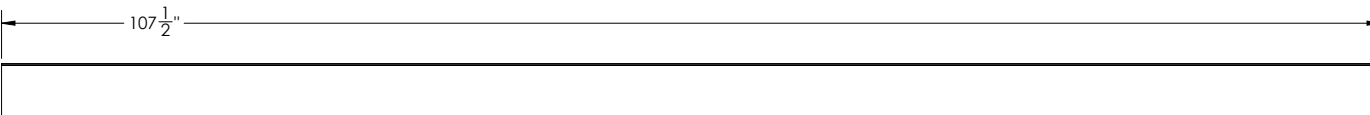
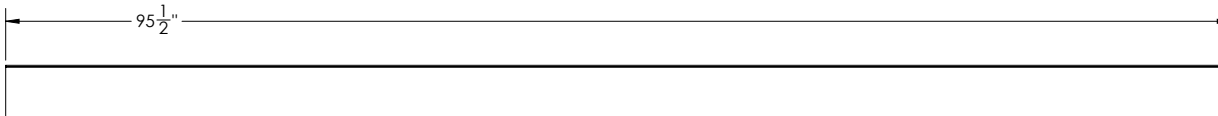
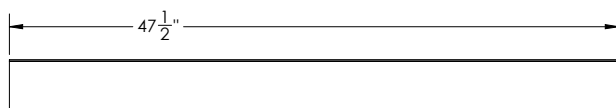
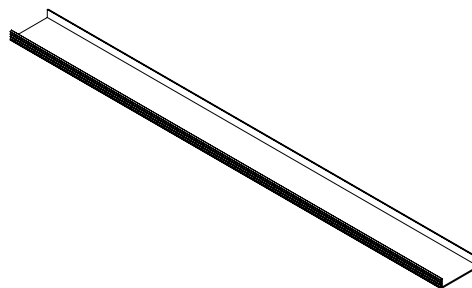

Infinity Drain
145 Dixon Avenue
Amityville, NY 11701
Phone: 516.767.6786
Fax: 516.740.3066
www.infinitydrain.com



NOTE: Installer must verify all rough-in dimensions prior to installation and consult local and national codes. Conformity and compliance to local and national codes are the responsibility of the installer.