

FT Series

FTED 25, FTDG 25, FTMN 25, FTAS 25,
FTED 65, FTDG 65, FTMN 65, FTAS 65, FTTIF 65

Parts List

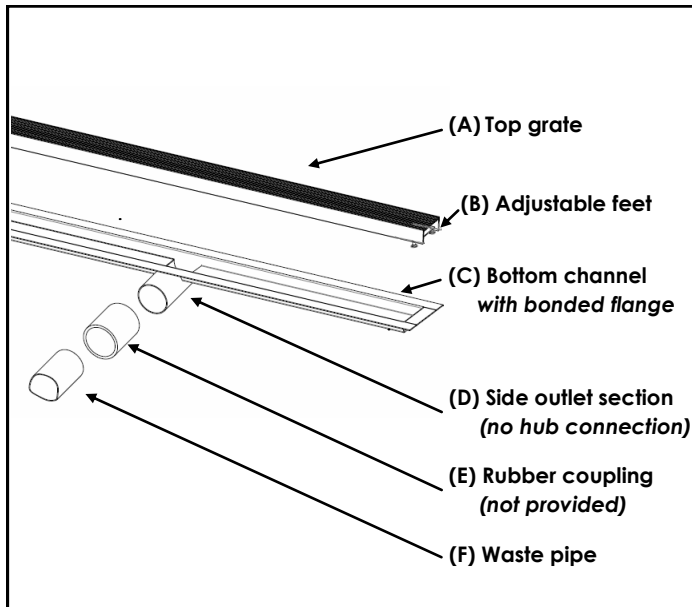

Figure 1

Installation Instructions

1. The Fixed Flange Series installs per IAPMO IGC 195-2010. Waterproof per Tile Council North America, B422-09, using ANSI 118/10 approved waterproofing.
2. Connect outlet (D) to waste pipe (F) via 2" no hub connection using a rubber coupling (E)* (*not provided). Note: outlet section (D) is 3" long and can be modified for height adjustment. Grate (A) has adjustable feet for finer adjustment (Minimum tile height $\frac{3}{8}$ ", maximum tile height $\frac{3}{4}$ ") Note: FTTIF Series (LA) grate, does not have adjustable feet.
3. Using a mortar bed, set and level channel (C).
4. Spread mortar bed, slope $\frac{1}{4}$ " per foot away from drain in a single plane. Note: tile height finishes $\frac{1}{16}$ " higher than grate height.
5. Apply waterproofing per manufacturer's instructions. Note: Waterproofing onto all four sides of 1" channel (C) flange. **Do not** waterproof inside bottom of channel.
6. Take measure to protect grate (A) prior to tiling. Keeping the grate (A) in the channel (C) thin set and tile onto waterproof membrane. Ensure tile allows for clearance of grate removal (A). Tile finishes $\frac{1}{16}$ " higher than grate.
7. Adjust grate (A) height with adjustable feet (B) as needed. The minimum height is achieved by removing adjustable feet/screws. Note: (LA) Grate is for a tile insert. (LA) grate interior will accommodate up to a $\frac{3}{8}$ " tile. Use a thin set adhesive to set tile into grate when using the FTTIF, the maximum finish floor height should be $\frac{1}{2}$ ".

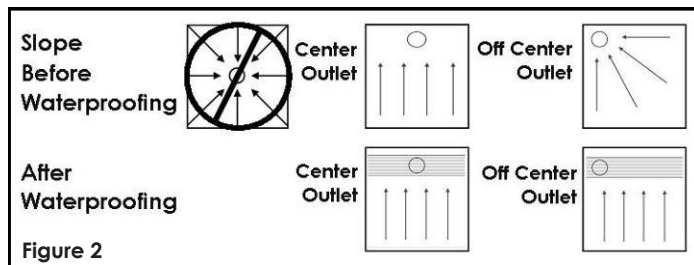
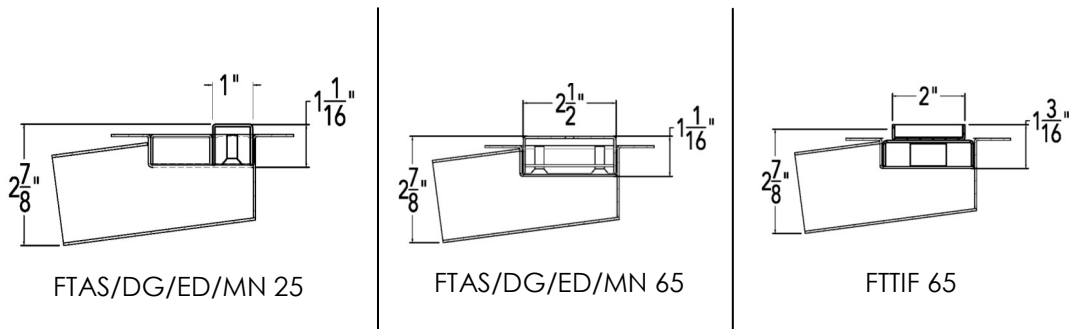

Figure 2

Infinity Drain recommends this product be installed by a licensed contractor



Screws can be adjusted for up to $\frac{1}{2}$ " additional height